



**CHECKBALL PISTON PUMPS
PF500 SERIES, 11 DESIGN**

PF5*-***-11**

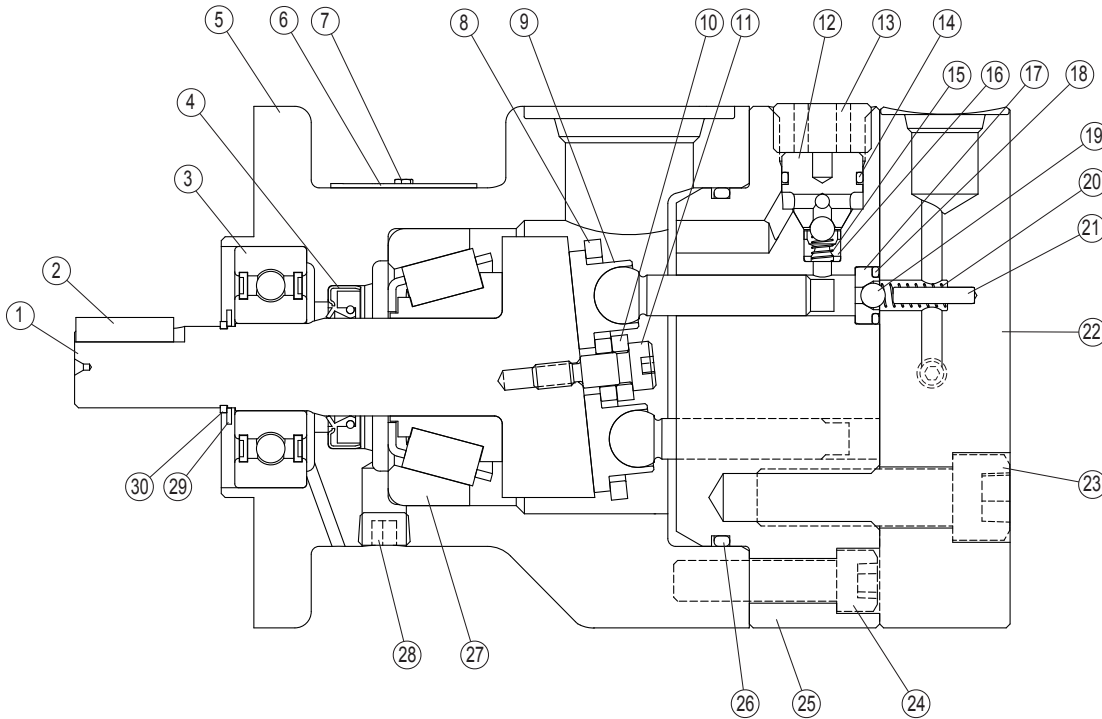

TABLE A – PARTS LIST

ID Number	Part Number	Part Description	Quantity Required
1	See Table B	Camshaft	1
2	1018.325	Key	0or1
3	1103.155	Shaft Bearing (Front)	1
4	See Table C	Shaft Seal	1
5	1218.277	Housing	1
6	1137.026	Nameplate	1
7	1001.003	Screw (Nameplate)	2
8	1448.101	Holdown Plate	1
9	See Table E	Piston Subassembly	2or4
10	1095.132	Spacer	1
11	1062.048	Shoulder Bolt ^①	1
12	1124.290	Inlet Check Seat	4
13	1577.006	Plug ^②	4
14	See Table C	O-ring (Inlet Check Seat)	4
15	See Table E	Spring (Inlet) ^③	2or4
16	See Table E	Inlet Ball Stop ^{③⑥}	2or4
17	1102.290	Outlet Check Seat	4
18	See Table C	O-ring (Outlet Check Seat)	4
19	1005.016	Checkball (Inlet/Outlet) ^⑧	6or8

ID Number	Part Number	Part Description	Quantity Required
20	1296.110	Spring (Outlet)	4
21	1123.061	Cover Pin ^⑦	4
22	See Table D	Cover	1
23	1383.028	Socket-head Capscrew ^④	4
24	1351.028	Socket-head Capscrew ^⑤	4
25	1239.050	Barrel	1
26	See Table C	O-ring	1
27	1102.155	Bearing	1
28	1007.245	Plug (Drain Port)	1
29	1156.108	Shim	1
30	1167.049	Retaining Ring	1

- ① Apply Loctite #271 or equivalent. Torque to 66 lb-in (7 N·m).
- ② Torque to 45 lb·ft (61 N·m).
- ③ Apply Loctite #680 or equivalent.
- ④ Torque to 70 lb·ft (95 N·m).
- ⑤ Torque to 25 lb·ft (34 N·m).
- ⑥ Quantity equals number of pistons. See Table E.
- ⑦ Pin included in Cover Assembly Kit. See Table D.
- ⑧ Quantity equals number of pistons +4. See Table E.

TABLE B – OUTPUT FLOW, CAMSHAFT

Output Flow Code	Cam Shaft	
	Keyed	Spline
01	1149.288	1159.288
04	1152.288	1162.288
07	1155.288	1165.288
10	1158.288	1168.288

TABLE C – SEAL KITS

Seal Code	Description	Kit Number
No Code	All Fluorocarbon (Viton® or Fluorel®) with Buna-N (Nitrile) Shaft Seal	KP05009010
XV	All Fluorocarbon (Viton® or Fluorel®) with High Pressure Shaft Seal	KP05009011
XE	All EPR with High Pressure Shaft Seal ^①	KP05009012

^① Contact the Dynex Sales department for recommended operating conditions with EPR seals.

TABLE D – PORT, COVER KITS

Port Code	Outlet Port Type	Cover Kit Number
No Code	Full Flow SAE	KP05119050
A	Full Flow Coned and Threaded	KP05119051
B	Full Flow BSPP	KP05119052
No Code	2+2 Split Flow SAE	KP05119220
A	2+2 Split Coned and Threaded	KP05119221
B	2+2 Split Flow BSPP	KP05119222
No Code	3+1 Split Flow SAE	KP05119310
A	3+1 Split Flow Coned and Threaded	KP05119311
B	3+1 Split Flow BSP	KP05119312
No Code	4x Split Flow SAE	KP051194X0
A	4x Split Coned and Threaded	KP051194X1
B	4x Split Flow BSPP	KP051194X2

TABLE E – PISTON, SEAT AND CHECK ITEMS

Item	Part Number	Description	Quantity
PF5XX(X)-XXX-XX-11			
9	3007.900	Piston Subassembly	4
15	1295.110	Spring (Inlet)	4
16	1104.290	Inlet Ball Stop	4
19	1005.016	Checkball (Inlet/Outlet)	8
PF5XX(X)-XXX-2-11 ^①			
9	3007.900	Piston Subassembly	2
15	1295.110	Spring (Inlet)	2
16	1104.290	Inlet Ball Stop	2
19	1005.016	Checkball (Inlet/Outlet)	6

^① This 2 piston pump is available in Full Flow version only.