

Solenoid Operated Pneumatic Valves

3/2 Way Single Solenoid Control Valve G1/8 & G1/4 Ports

Technical information

Pressure range:	2.5-10 bar
Temperature range:	-15°C...+50°C
Housing:	Glass fibre reinforced PPA
Seals:	NBR
Lubricant:	Not required
Earthing contact:	Part of the standard device.
Operating medium:	5 micron filtered, lubricated or non-lubricated compressed air.



Other information

For NPT ports use prefix code "75" for example 75.XXX.XX.XX
 For vacuum please use code 76.7XX.XX.XX
 Order coils & connecting plugs separately, see data sheet M1002.

Symbol	Description	Type	Orifice	Ports	Order code
	3/2 way normally closed spring return	Poppet	6mm	G1/8	76.126.01.00
	3/2 way normally closed spring return	Poppet	8mm	G1/4	76.146.01.00
	3/2 way normally open spring return	Poppet	6mm	G1/8	76.126.11.00
	3/2 way normally open spring return	Poppet	8mm	G1/4	76.146.11.00

Dimensional drawings

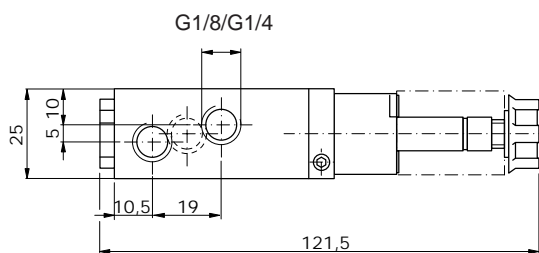
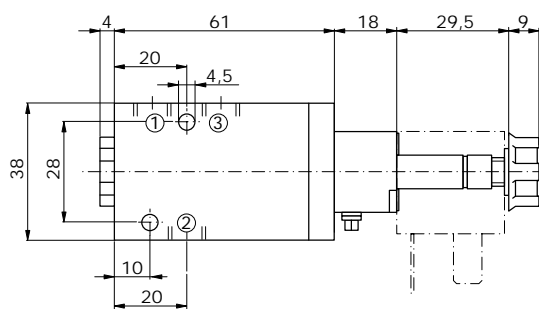

Flow rate orifice 6mm poppet type

kv=12,3 l/min

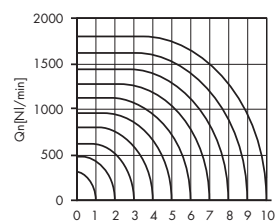

P2[bar]

Flow rate orifice 8mm poppet type

kv=15,8 l/min

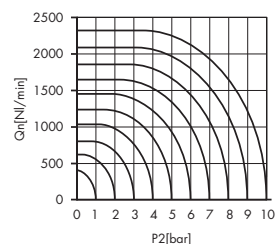

P2[bar]