

## BIFFI MORIN S SERIES ACTUATORS

Stainless steel spring return and double acting pneumatic quarter-turn actuators  
Output torques to 13545 Nm

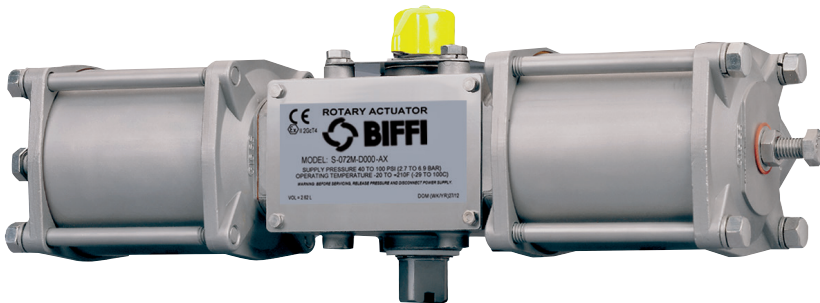

### FEATURES AND BENEFITS

- Innovative stainless steel construction provides superior internal and external corrosion resistance.
- Scotch yoke design using precision bearings eliminates dead band in the yoke mechanism, providing the greatest torque output at the beginning and end of stroke.
- High strength 17-4PH stainless steel shaft transmits torque and gives long service life.
- Heat-treated stainless steel thrust pin and rollers transfer piston force to yoke to reduce friction for longer life and more efficient torque transmission.
- Bi-directional travel stops provide accurate valve rotation adjustment.
- PTFE piston bearings, piston rod bushings and output shaft bushings provide longer life, reduce maintenance and require no lubrication.
- Universal design position indicator and pointer allows for either parallel or perpendicular mounting.
- Stainless steel construction allows proximity switches to be direct-mounted in the actuator housing, eliminating the need to mount bracket and cam assemblies on top.
- NAMUR drive slot maintains a compact assembly for accessory-driven components with no couplings necessary.
- Available in symmetrical and canted yoke design to suit application.
- Spring return model design requires no special tools to disarm springs safely and easily, reducing down time.

### GENERAL APPLICATIONS

For remote control of any quarter-turn application: ball, butterfly, rotary plug or damper style valves, etc. To be used in chemical process, food and beverage, iron and steel, off-shore marine, pharmaceutical, power, oil and gas, pulp and paper, and textile industries.

### TECHNICAL DATA

Supply pressure:	3 to 11 bar (see torque charts)
Supply medium:	Air or any gas compatible with materials of construction
Temperature rating	
Standard range:	-29°C to 99°C
Optional range:	-54°C to 149°C
Angular rotation:	90 degrees (adjustable between 82 and 98 degrees)
Mounting pattern:	ISO 5211
Protection:	IP66; IP68 (optional)
Certification:	SIL3 capable

# BIFFI MORIN S SERIES ACTUATORS

## DESIGNED WITH A HEART OF STAINLESS STEEL

### Stainless steel yoke

The heart of any scotch yoke actuator is the yoke. S series actuators use 17-4PH stainless for this critical area as standard.

The yoke is the mechanism used to convert linear force to torque. This area is most often where the life of the actuator is controlled.

### Principles of construction

Using high quality materials of construction and modern rugged design concepts provides the standard for high quality, low cost valve actuation.

The S actuator housings are all machined from 316 stainless steel castings. This produces a rugged, low cost product through reduced machining time and by eliminating wasteful excess material.

Any components that rotate or slide during operation, such as the high strength stainless steel output shaft, stainless steel piston rod, stainless steel thrust pin or the stainless steel piston, are all supported by replaceable friction reducing bearings.

### Bi-directional travel stops

Adjustable stops on each end cap provide the flexibility of accurate valve rotation positioning at the end of the 'open' and 'close' stroke. Both stops are located on the cylinder centerline, the optimal position to maximize travel adjustment and eliminate any detrimental side loading on the travel stops. Adjustable from 82° to 98°.

### Ingress protection

Standard IP66. Optional IP68.

### Spring designed for safety

All spring return models incorporate a 'man-safe' spring design that allows the actuator to be safely assembled and disassembled in the field without the need for special tools. The integral tie rods are bored and tapped to provide a means of loading and unloading the spring in a safe and convenient manner.

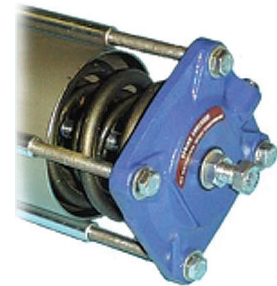
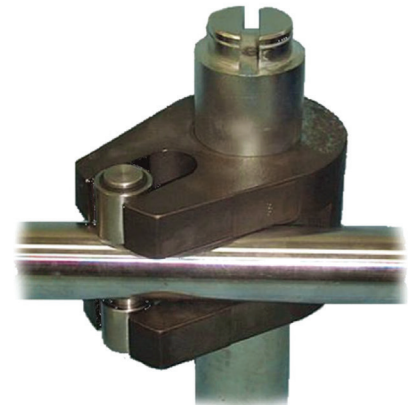

## SYMMETRICAL SCOTCH YOKE TORQUE CHARACTERISTICS

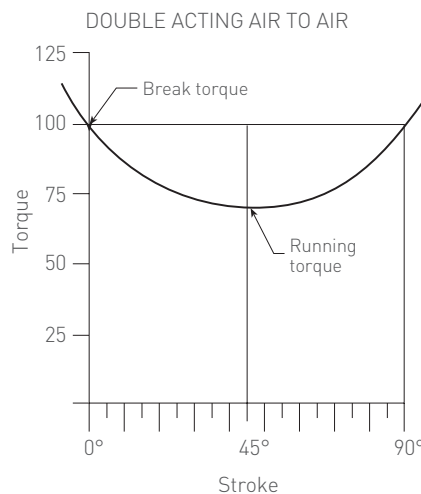
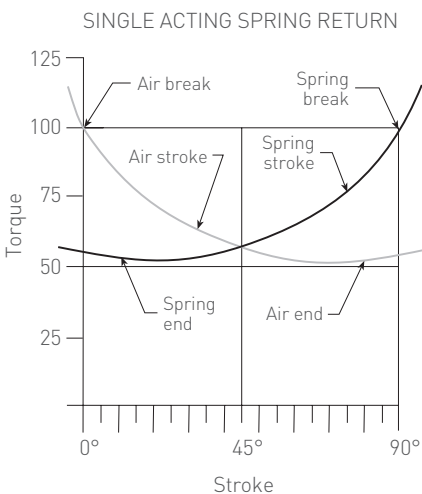

## AVAILABLE OPTIONS

- Jackscrew override
- Hydraulic override
- Full stroke adjustment
- Proximity preparation
- Lockout device
- Partial stroke test

# BIFFI MORIN S SERIES ACTUATORS

## MATERIALS OF CONSTRUCTION

DOUBLE ACTING - MODELS 003 TO 100

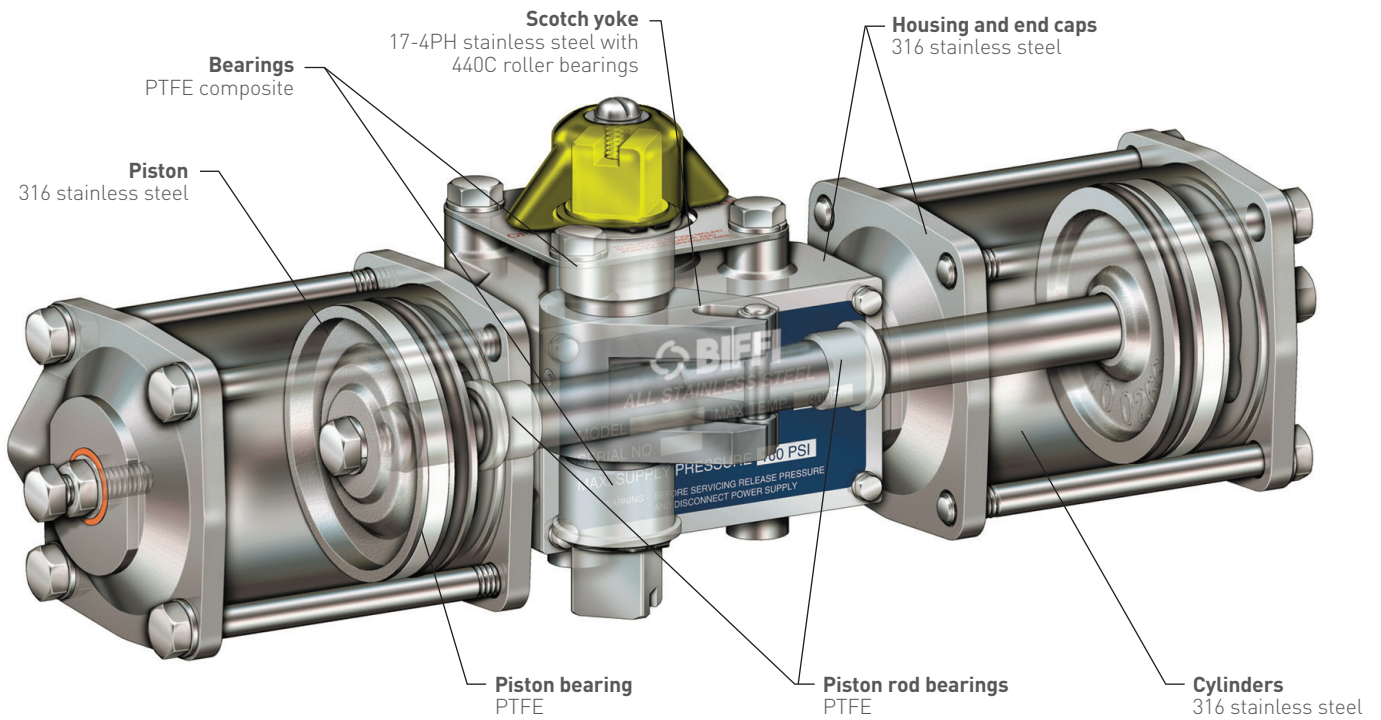

DOUBLE ACTING - MODELS 135 TO 1150

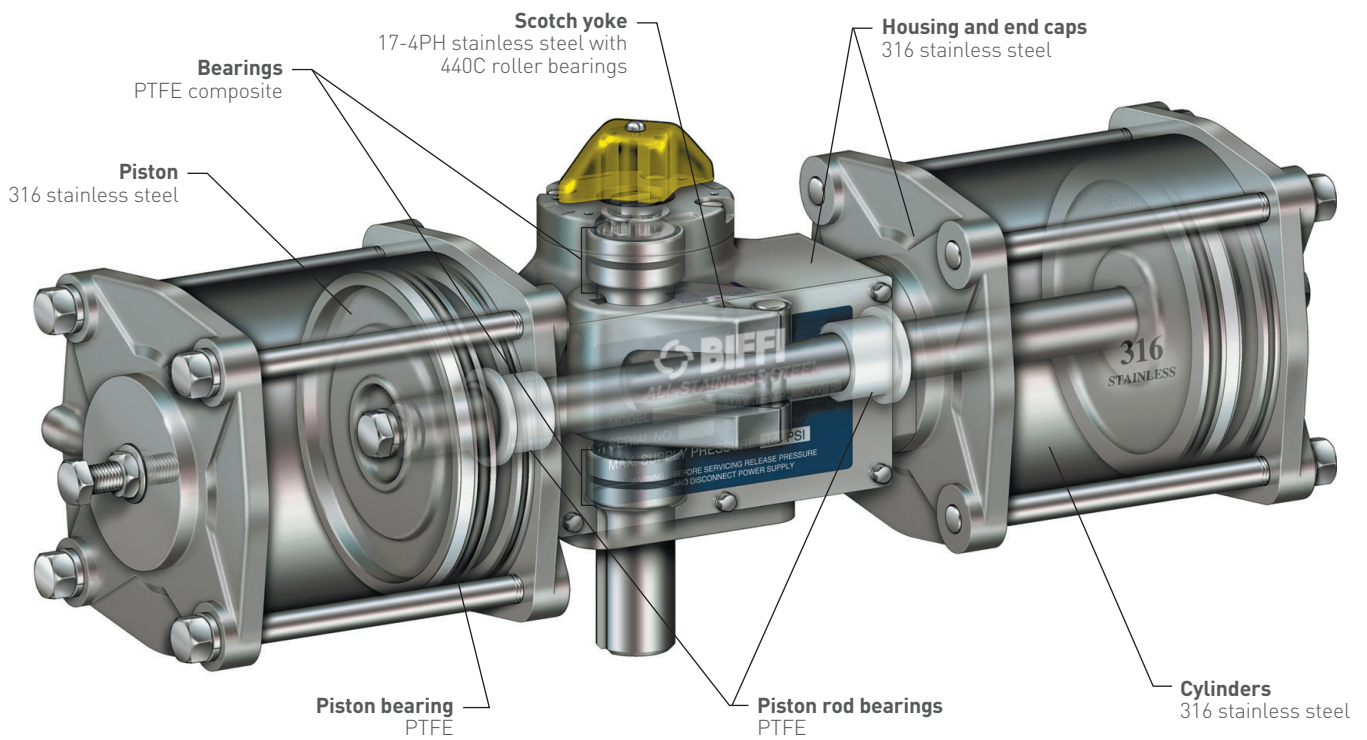



# BIFFI MORIN S SERIES ACTUATORS

## OPTIONS

### MANUAL OPTIONS

To provide the actuation package best suited for your application, we offer a full range of manual accessories.

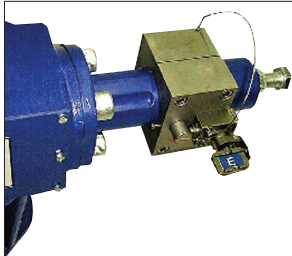

#### Partial stroke test device (PSTD)

Provides a method of testing ESD packages without shutdown.



#### Lockout

Integral lockout allows safe shutdowns for maintenance and isolation of systems.

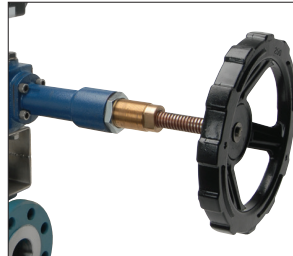

#### Jackscrew override (JSO)

Manual operation when power is lost. Simple and effective.



#### Hydraulic override (MHP)

Manual operation when power is lost. Includes speed controls.



#### AWWA

Tested per American Waterworks Association C540. Available for pneumatic or water service operation.

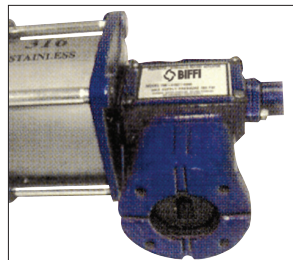

#### Direct mounting cast adapters

Many valve top works covered, including some ISO mounting. Assures economic but correct mounting alignment.

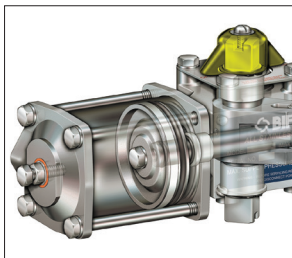

#### Full stroke adjuster

Provides mechanical control of maximum and/or minimum valve stroke.

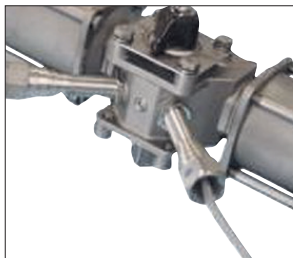

#### Proximity switch preparation

Allows installation of cartridge style proximity switches. Leaves top works open for mounting of other devices.

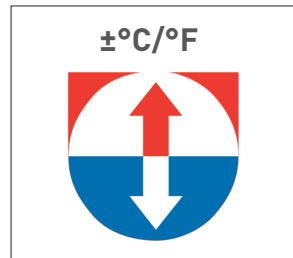

#### High or low temperature ratings

Standard rating of -29°C to 99°C [-20°F to 210°F] covers most applications. Optional ratings down to -54°C [-65°F] and up to 149°C [300°F].

# BIFFI MORIN S SERIES ACTUATORS

## MECHANICAL DATA

Actuator model	Number of pistons	Cylinder bore (mm)	Stroke (mm)	Volume <sup>[1]</sup> (liters)	Cycle time <sup>[2]</sup>	Weight (kg)
				90° stroke	(seconds) 90° stroke	
<b>Double acting</b>						
003	1	57.2	38.1	0.10	0.3	2.27
006	1	69.9	50.8	0.20	0.5	4.54
012	2	69.9	50.8	0.38	0.7	5.44
023	1	111.1	76.2	0.74	1.0	12.25
036	1	138.1	76.2	1.15	1.5	13.61
050	1	158.8	76.2	1.51	2.2	14.97
059	2	111.1/138.1	76.2	1.84	2.4	16.33
072	2	138.1	76.2	2.25	2.5	17.23
100	2	158.8	76.2	2.98	3.0	20.87
135	1	209.6	127.0	4.38	4.5	74.84
210	1	260.4	127.0	6.77	5.0	83.91
270	2	209.6	127.0	8.62	6.0	95.25
345	2	209.6/260.4	127.0	11.00	7.0	104.78
370	1	311.2	152.4	11.59	8.0	176.90
420	2	260.4	127.0	13.37	8.5	116.57
575	1	393.7	152.4	18.55	9.5	235.41
740	2	311.2	152.4	22.86	10.0	240.40
945	2	311.2/393.7	152.4	29.82	11.0	296.20
1150	2	393.7	152.4	36.79	12.0	351.53
<b>Spring return</b>						
003	1	57.2	38.1	0.10	0.3	2.72
006	1	69.9	50.8	0.20	0.5	4.99
012	2	69.9	50.8	0.38	0.7	6.35
023	1	111.1	76.2	0.74	1.0	15.42
036	1	138.1	76.2	1.15	1.5	19.05
046	2	111.1	76.2	1.44	2.0	19.50
058	2	138.1/111.1	76.2	1.84	2.3	23.13
059	2	111.1/138.1	76.2	1.84	2.4	23.13
072	2	138.1	76.2	2.25	2.5	24.95
100	2	158.8	76.2	2.98	3.0	29.03
135	1	209.6	127.0	4.38	4.5	95.25
210	1	260.4	127.0	6.77	5.0	106.59
270	2	209.6	127.0	8.62	6.0	113.40
344	2	260.4/209.6	127.0	11.00	7.0	143.00
345	2	209.6/260.4	127.0	11.00	7.0	143.00
370	1	311.2	152.4	11.59	8.0	244.94
420	2	260.4	127.0	13.37	8.5	171.91
575	1	393.7	152.4	18.55	9.5	353.35
740	2	311.2	152.4	22.86	10.0	319.33
944	2	393.7/311.2	152.4	29.82	11.0	395.00
945	2	311.2/393.7	152.4	29.82	11.0	395.00
1150	2	393.7	152.4	36.79	12.0	490.79

## NOTES

### 1. Air consumption:

Liter shown in chart represent actual free air volume in cylinder between piston and end cap when furthest apart.

Air consumption will vary depending on supply pressure. To determine standard cubic meter per second use the following formula:

$$\left(\frac{\text{Vol. ltr.}}{1000}\right) \left(\frac{\text{Supply air barg} + 1}{1 \text{ barg}}\right) \left(\frac{\text{Strokes/min}}{60}\right)$$

Example: Calculate SCMS for model 023 double acting using 5.5 barg air supply and 5 strokes/minute.

$$\text{SCMS} = \left(\frac{0.737}{1000}\right) \left(\frac{5.5+1}{1 \text{ barg}}\right) \left(\frac{5}{60}\right) = 0.000401$$

2. Cycle times shown represent average time to stroke 90 degrees using standard pilot valves and should be used as a guide only. Cycle times can be increased or decreased dramatically by using speed controls, oversized pilot valves or quick exhaust valves.

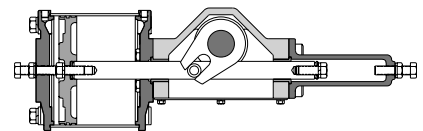

TYPICAL SECTION - double acting/one piston

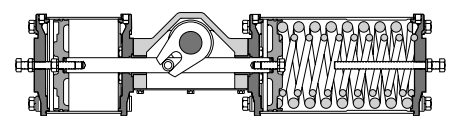

TYPICAL SECTION - spring return/two pistons

# BIFFI MORIN S SERIES ACTUATORS

## DIMENSIONS

MODELS 012, 046, 058, 059, 072 AND 100

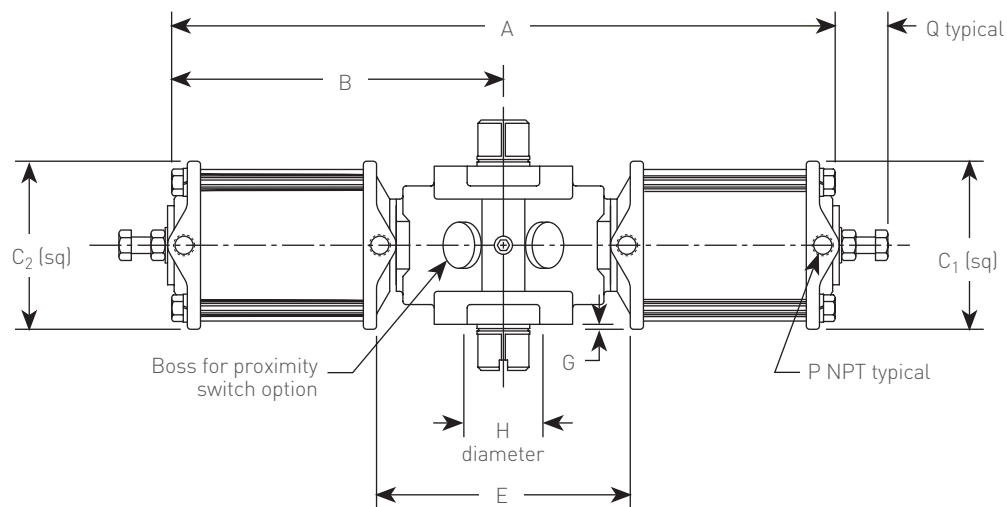

MODELS 003, 006, 023, 036 AND 050

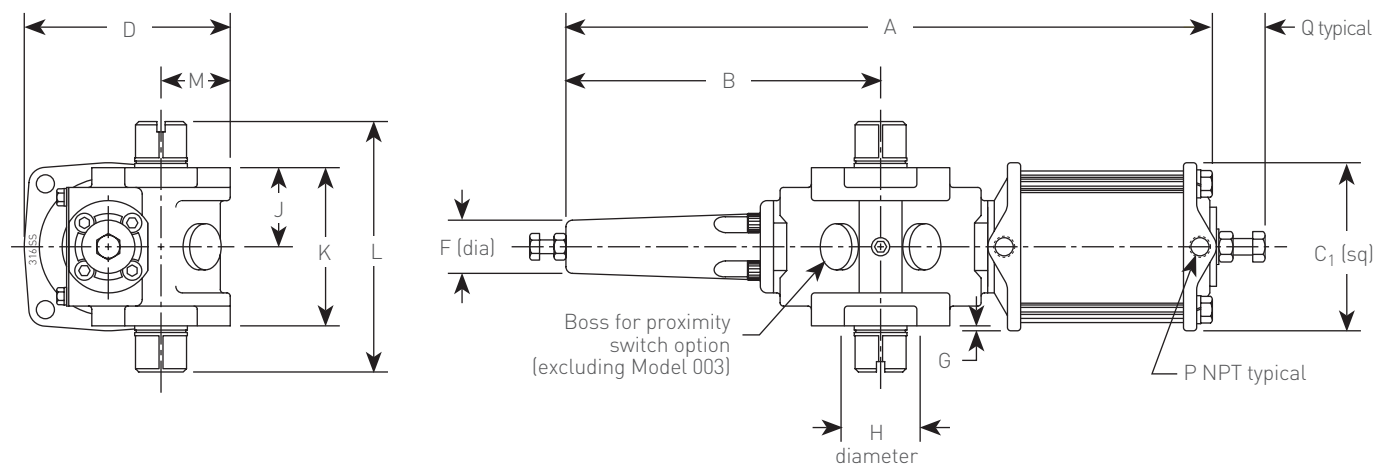

### NOTES

1. Shown without pointer for clarity.
2. For mounting dimensions, refer to pages 11 and 12.

# BIFFI MORIN S SERIES ACTUATORS

## DIMENSIONS

### DIMENSIONS (mm) DOUBLE ACTING

Model	A	B	C <sub>1</sub>	C <sub>2</sub>	D	E	F	G	H	J	K	L	M	P	Q
003DA	230.1	88.9	68.3	-	77.7	-	19.1	-	25.4	34.8	69.9	82.6	25.4	1/8	15.7
006DA	313.4	151.6	80.8	-	99.3	-	25.4	2.5	35.1	38.1	76.2	120.7	33.3	1/8	25.4
012DA	323.6	161.8	80.8	80.8	99.3	122.2	-	2.5	35.1	38.1	76.2	120.7	33.3	1/8	25.4
023DA	472.4	223.8	122.2	-	146.8	-	36.3	6.4	44.5	54.9	109.5	169.9	47.8	1/4	29.2
036DA	469.4	223.8	147.6	-	159.5	-	36.3	19.1	44.5	54.9	109.5	169.9	47.8	1/4	31.8
050DA	469.6	223.8	181.1	-	176.3	-	36.3	35.8	44.5	54.9	109.5	169.9	47.8	1/4	31.8
072DA	491.0	245.6	147.6	147.6	159.5	162.1	-	19.1	44.5	54.9	109.5	169.9	47.8	1/4	21.1
100DA	491.5	245.9	180.8	180.8	176.3	162.1	-	35.8	44.5	54.9	109.5	169.9	47.8	1/4	19.1

### DIMENSIONS (mm) SPRING RETURN

Model	A	B	C <sub>1</sub>	C <sub>2</sub>	D	E	F	G	H	J	K	L	M	P	Q
003SR	230.1	88.9	68.3	-	77.7	-	19.1	-	25.4	34.8	69.9	82.6	25.4	1/8	15.7
006SR	366.8	151.6	80.8	-	99.3	-	25.4	2.5	35.1	38.1	76.2	120.7	33.3	1/8	25.4
012SR	376.9	161.8	80.8	80.8	99.3	115.6	-	2.5	35.1	38.1	76.2	120.7	33.3	1/8	25.4
023SR	554.2	223.8	122.2	-	146.8	-	36.3	6.4	44.5	54.9	109.5	169.9	47.8	1/4	31.8
036SR	597.2	223.8	147.6	-	159.5	-	36.3	19.1	44.5	54.9	109.5	169.9	47.8	1/4	31.8
046SR	579.1	248.7	122.2	122.2	150.6	158.5	-	6.4	44.5	54.9	109.5	169.9	47.8	1/4	31.8
058SR	578.9	247.1	147.5	122.2	169.2	141.7	-	19.1	44.5	54.9	109.5	169.9	57.1	1/4	31.8
059SR	620.8	245.4	122.2	147.6	169.2	138.2	-	19.1	44.5	54.9	109.5	169.9	57.1	1/4	31.8
072SR	619.0	245.6	147.6	147.6	159.5	152.1	-	19.1	44.5	54.9	109.5	169.9	47.8	1/4	31.8
100SR	619.3	245.9	180.8	180.8	176.3	152.1	-	35.8	44.5	54.9	109.5	169.9	47.8	1/4	31.8

# BIFFI MORIN S SERIES ACTUATORS

## DIMENSIONS

MODELS 270, 344, 345, 420, 740, 944, 945 AND 1150

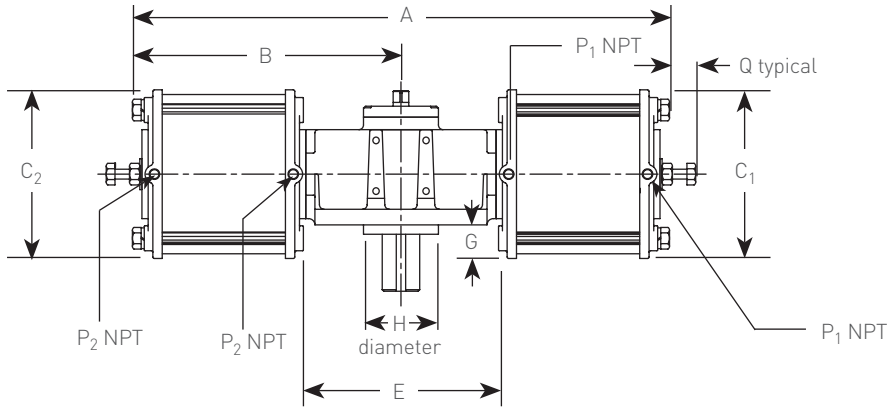

MODELS 135, 210, 370 AND 575

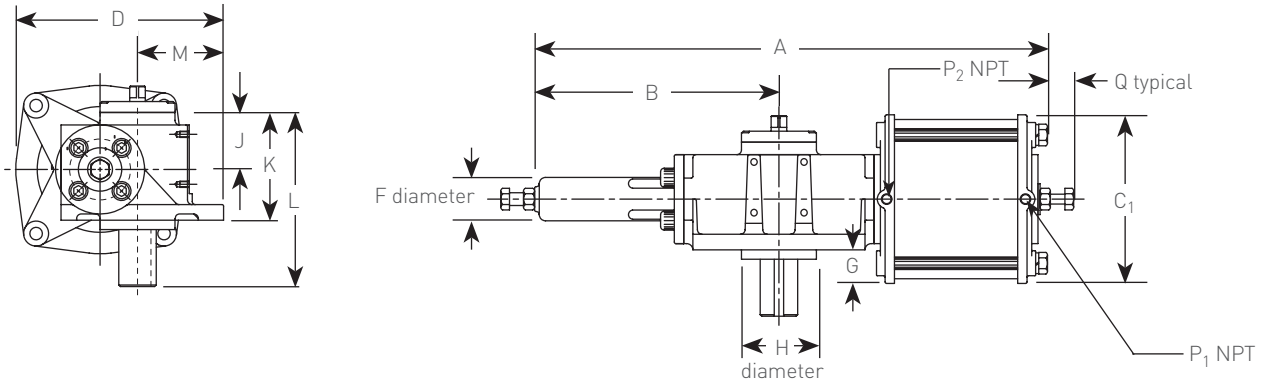

MODELS 1480 AND 2380 (OBSOLETE)

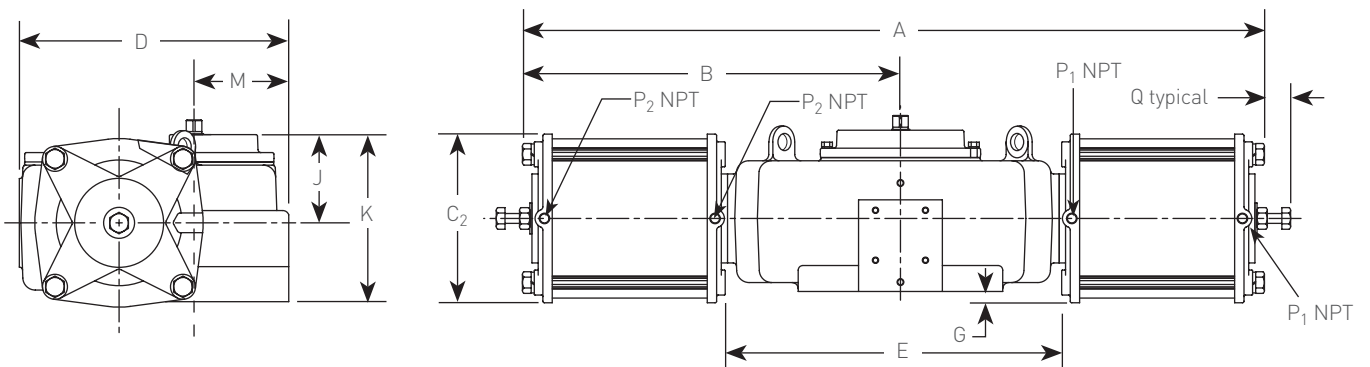

### NOTES

1. Shown without pointer for clarity.
2. For mounting dimensions, refer to pages 11 and 12.

# BIFFI MORIN S SERIES ACTUATORS

## DIMENSIONS

### DIMENSIONS (mm) DOUBLE ACTING

Model	A	B	C <sub>1</sub>	C <sub>2</sub>	D	E	F	G	H	J	K	L	M	P <sub>1</sub>	P <sub>2</sub>	Q
135DA	834.9	403.3	241.3	241.3	265.2	-	69.8	25.4	-	111.2	206.5	300.2	81.0	3/8	3/8	38.1
210DA	844.8	403.3	292.1	292.1	290.6	-	69.8	50.8	-	111.2	206.5	300.2	81.0	1/2	1/2	50.8
270DA	863.3	431.5	241.3	241.3	265.9	297.7	-	25.4	-	111.2	206.5	300.2	81.0	3/8	3/8	38.1
345DA	839.4	413.8	232.7	281.7	280.3	281.0	-	49.0	-	107.3	199.2	289.6	78.2	3/8	1/2	51.9
370DA	1057.7	501.6	342.9	342.9	425.4	-	88.9	68.3	152.4	138.2	241.3	376.2	174.7	1/2	1/2	38.1
420DA	882.6	441.4	292.1	292.1	290.6	284.9	-	50.8	-	111.2	206.5	300.2	81.0	1/2	1/2	44.4
575DA	1077.5	501.6	431.8	431.8	469.9	-	88.9	114.3	152.4	138.2	241.3	376.2	174.7	3/4	3/4	50.8
740DA	1121.4	509.8	342.9	342.9	425.4	393.7	-	68.3	152.4	138.2	241.3	376.2	174.7	1/2	1/2	38.1
945DA	1096.9	540.7	330.7	416.5	453.2	373.6	-	108.8	144.5	133.3	232.7	362.8	168.6	1/2	3/4	61.2
1150DA	1152.9	576.3	431.8	431.8	469.9	377.9	-	114.3	152.4	138.2	241.3	376.2	174.7	3/4	3/4	46.9

### DIMENSIONS (mm) SPRING RETURN

Model	A	B	C <sub>1</sub>	C <sub>2</sub>	D	E	F	G	H	J	K	L	M	P <sub>1</sub>	P <sub>2</sub>	Q
135SR	1002.3	403.3	241.3	241.3	265.2	-	69.8	25.4	-	111.2	206.5	300.2	81.0	3/8	3/8	44.4
210SR	1083.8	403.3	292.1	292.1	290.6	-	69.8	50.8	-	111.2	206.5	300.2	81.0	1/2	1/2	53.8
270SR	1030.5	431.5	241.3	241.3	265.2	278.1	-	25.4	-	111.2	206.5	300.2	81.0	3/8	3/8	44.4
344SR	1003.3	425.8	281.7	232.7	280.3	262.1	-	49.0	-	107.3	199.2	289.6	78.2	1/2	3/8	51.9
345SR	1072.9	416.3	232.7	281.7	280.3	259.9	-	49.0	-	107.3	199.2	289.6	78.2	3/8	1/2	51.9
370SR	1320.8	501.6	342.9	342.9	425.4	-	88.9	68.3	152.4	138.2	241.3	376.2	174.7	1/2	1/2	44.4
420SR	1121.9	441.4	292.1	292.1	290.6	263.1	-	50.8	-	111.2	206.5	300.2	81.0	1/2	1/2	53.8
575SR	1377.9	501.6	431.8	431.8	469.9	-	88.9	114.3	152.4	138.2	241.3	376.2	174.7	3/4	3/4	63.5
740SR	1370.6	560.6	342.9	342.9	425.4	374.6	-	68.3	152.4	138.2	241.3	376.2	174.7	1/2	1/2	53.8
944SR	1377.4	555.4	416.5	330.7	453.2	352.1	-	108.8	144.5	133.3	232.7	362.8	168.6	3/4	1/2	61.2
945SR	1387.4	540.7	330.7	416.5	453.2	346.9	-	108.8	144.5	133.3	232.7	362.8	168.6	1/2	3/4	61.2
1150SR	1454.1	576.3	431.8	431.8	469.9	349.2	-	112.8	152.4	138.2	241.3	376.2	174.7	3/4	3/4	63.5

# BIFFI MORIN S SERIES ACTUATORS

## DIMENSIONS

### MODEL 003 - TOP AND BOTTOM OF HOUSING

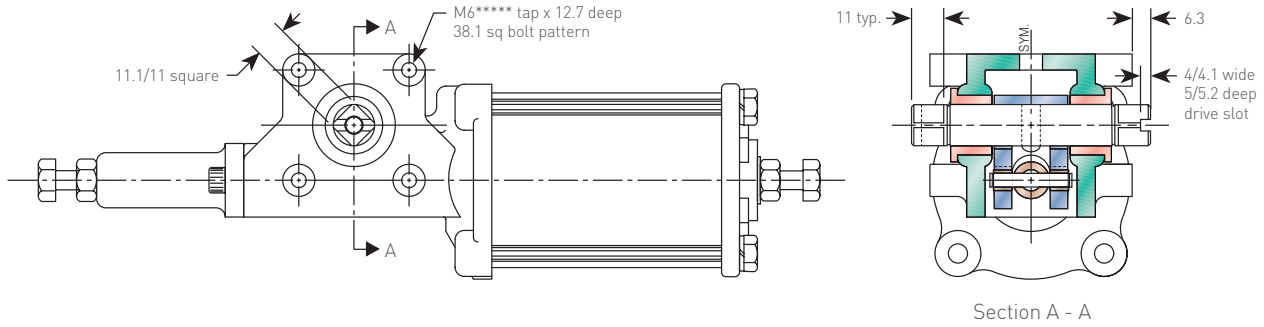

### MODELS 006 TO 100 AND 144 - TOP AND BOTTOM OF HOUSING

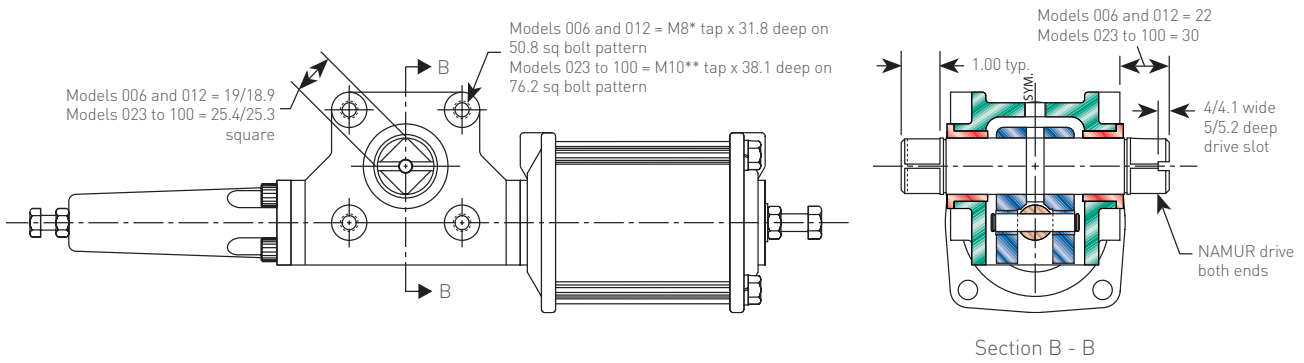

### MODELS 135, 210, 270, 344, 345 AND 420 - BOTTOM OF HOUSING ISO 5211-F16

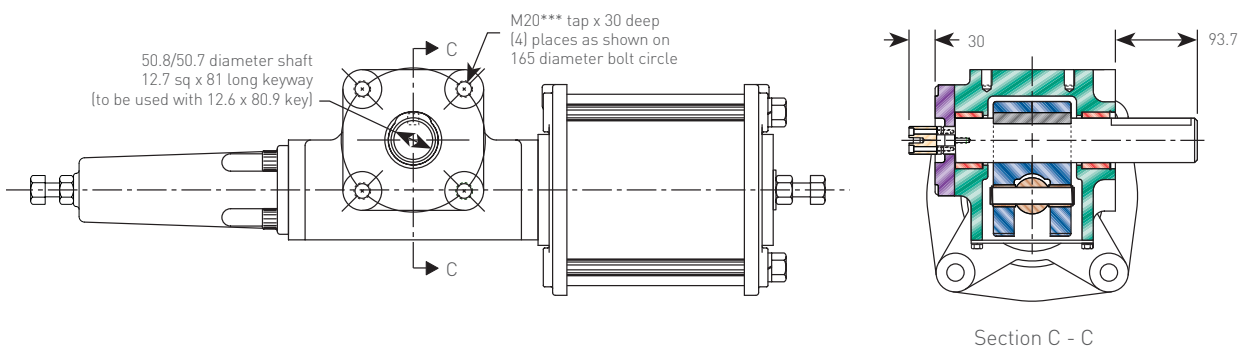

### MODELS 135, 210, 270, 344, 345 AND 420 - TOP OF HOUSING - MOUNTING DETAILS

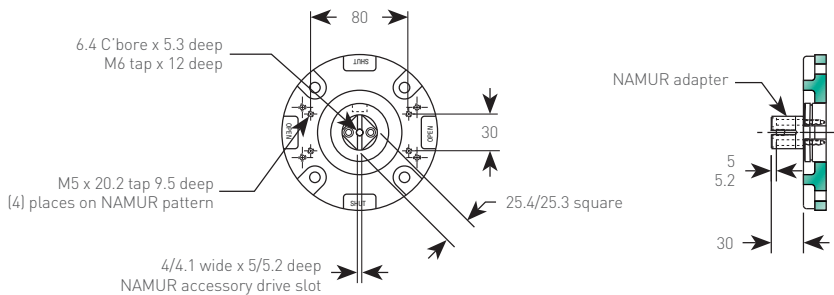

### IMPERIAL THREAD OPTION

Standard tap	Model number
* 5/16 - 18 UNC	006 and 012
** 3/8 - 16 UNC	023 to 100
*** 3/4 - 10 UNC	135 to 1150
**** 1/4 - 20 UNC	003

Replace 'M' with 'U' in order number designation (refer to page 13).

# BIFFI MORIN S SERIES ACTUATORS

## MOUNTING DETAILS

MODELS 370, 575, 740, 944, 945 AND 1150 - BOTTOM OF HOUSING ISO 5211-F30

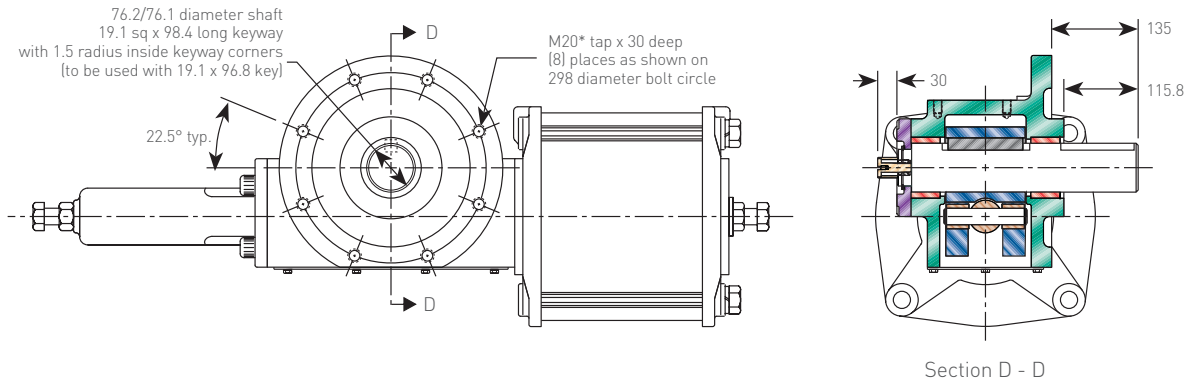

MODELS 370, 575, 740, 944, 945 AND 1150 - TOP OF HOUSING - MOUNTING DETAILS

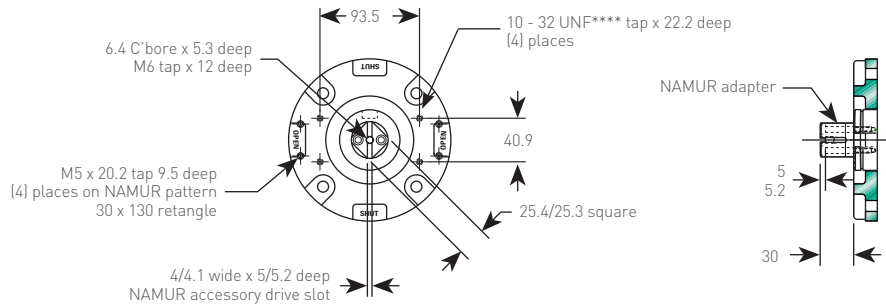

MODELS 1480 AND 2380 - BOTTOM OF HOUSING ISO 5211-F35 (OBSOLETE)

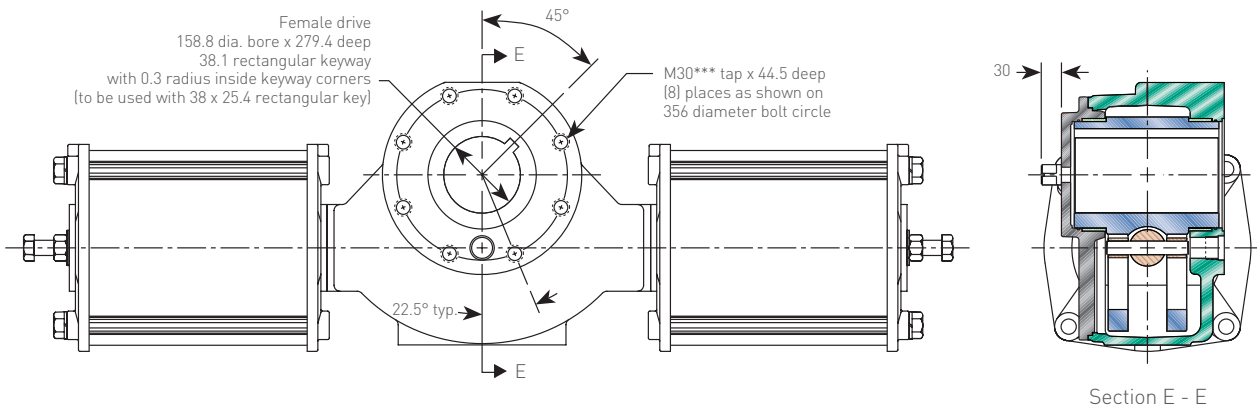

MODELS 1480 AND 2380 - TOP OF HOUSING - MOUNTING DETAILS (OBSOLETE)

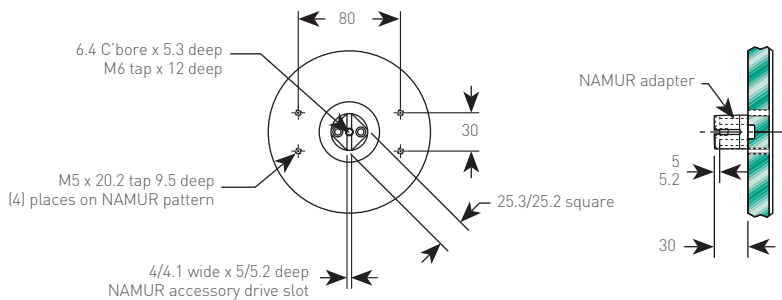

### IMPERIAL THREAD OPTION

Standard tap	Model number
* 3/4 - 10 UNC	370 and 575 to 1150
*** 1 - 8 UNC	1480 and 2380 (OBSOLETE)

Replace 'M' with 'U' in order number designation  
(refer to page 13).

# BIFFI MORIN S SERIES ACTUATORS

## ORDERING INFORMATION

### SELECTION GUIDE

<b>Actuator model</b>																													
S-	Stainless steel																												
<b>Actuator size</b> Model code based on approximate torque of symmetrical double acting at 5.5 barg																													
270	<table border="1"> <tr> <td>003</td> <td>058</td> <td>344</td> <td>945</td> </tr> <tr> <td>006</td> <td>059</td> <td>345</td> <td>1150</td> </tr> <tr> <td>012</td> <td>072</td> <td>370</td> <td></td> </tr> <tr> <td>023</td> <td>100</td> <td>420</td> <td></td> </tr> <tr> <td>036</td> <td>135</td> <td>575</td> <td></td> </tr> <tr> <td>046</td> <td>210</td> <td>740</td> <td></td> </tr> <tr> <td>050</td> <td>270</td> <td>944</td> <td></td> </tr> </table>	003	058	344	945	006	059	345	1150	012	072	370		023	100	420		036	135	575		046	210	740		050	270	944	
003	058	344	945																										
006	059	345	1150																										
012	072	370																											
023	100	420																											
036	135	575																											
046	210	740																											
050	270	944																											
<b>Interface bolting</b>																													
U -	UNC mounting threads																												
M -	Metric mounting threads																												
<b>Yoke design</b>																													
(blank) -	Symmetrical yoke																												
C -	Canted yoke																												
<b>Function</b>																													
D -	Double acting																												
S -	Spring return																												
<b>Spring code</b>																													
00	00 - No spring - Double acting																												
	04 - 40 pound spring																												
	05 - 50 pound spring																												
	06 - 60 pound spring																												
Etc. see Morin Torque Book for available springs																													
<b>Spring return failure rotation</b>																													
0 -	No spring (double acting OR actuator rotates clockwise on loss of air)																												
1 -	Actuator rotates counterclockwise on loss of air																												
<b>Option</b>																													
(blank) -	No options (standard configuration)																												
See complete modules code listing																													
<b>Note:</b> Some codes can be used in combination. Indicate by "stacking" separated by "-".																													
Consult factory for possible combinations combinations.																													
S-	270 U C - D 00 0 - JSO = Model number <b>S-270UC-D000-JSO</b>																												

### HOW TO ORDER

1. Double acting example	2. Spring return example	3. For all spring return models
Air supply: 5.5 barg	Air supply: 5.5 barg	Use air pressure to determine spring set
Break torque: 813.6 Nm	Ending torque: 1463.4 Nm	All spring sets ending with "0" fail clockwise (40, 50, 60, etc.)
	Fail rotation: clockwise	All spring sets ending with "1" fail counterclockwise (41, 51, 61, etc.)
<b>S-072U-D000</b>	<b>S-370U-S080</b>	
<b>S</b> Series	<b>S</b> Series	
<b>072</b> Model number	<b>370</b> Model number	
<b>U</b> UNC mounting threads	<b>U</b> UNC mounting threads	
<b>D000</b> Double acting	<b>S080</b> Spring set	

# BIFFI MORIN S SERIES ACTUATORS

ALSO AVAILABLE

## THE B AND C SERIES ACTUATORS

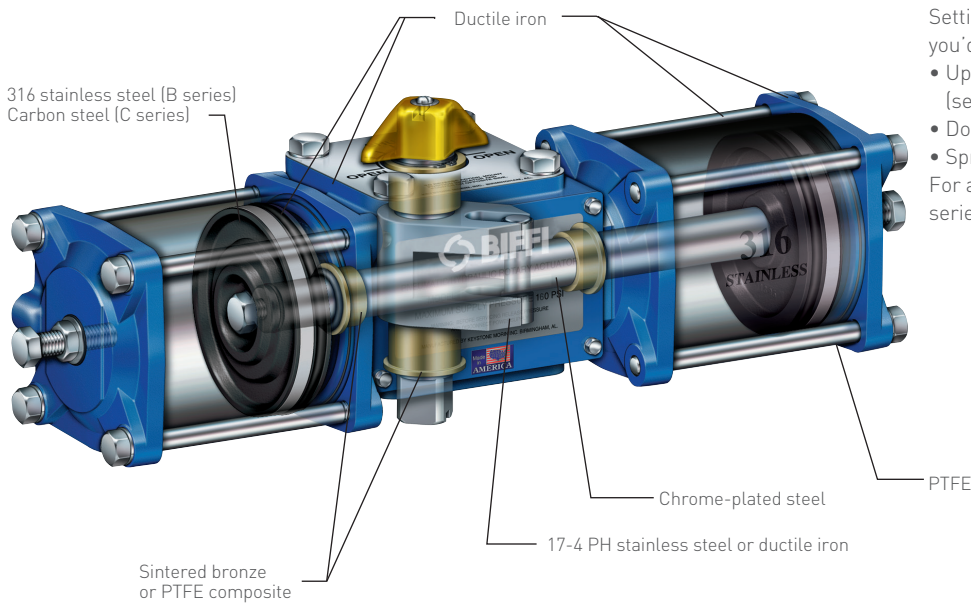

Setting a new standard in actuation at a price you'd expect from a commodity product.

- Up to 11 barg operating pressure [see torque chart].
- Double acting break torques to 158200 Nm.
- Spring end torques to 65903 Nm.

For additional information, refer to B and C series data sheet.

## THE HP SERIES ACTUATOR

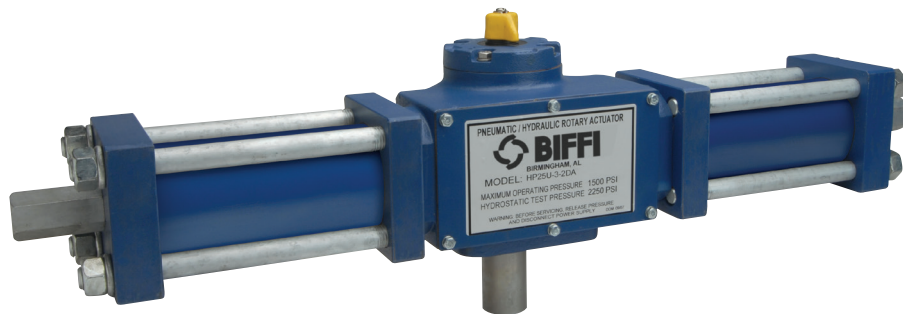

High pressure actuation with Xylan® coated carbon steel cylinders for superior corrosion resistance.

- Up to 155 bar operating pressure [see torque chart].
- Double acting torques to 90400 Nm.
- Spring end torques to 45200 Nm.

For additional information, refer to HP Series data sheet.



Biffi reserves the the right to change product designs and specifications without notice.