

Control and signalling devices

Contact element for installat. on mount. rail

Ex e

8082/1-1-00 Art. No. 132636



- Wide selection of different actuators
- Versions as NC with positive opening, NO or disconnect terminal

MY R. STAHL 8082A



R. STAHL Series 8082 contact elements have an NO contact and a positive opening NC contact, either made of silver-nickel or gold-plated. They can easily be combined to form contact blocks and enable customised installations, in part due to the wide selection of different actuators.

Technical Data

Explosion Protection	
Application range (zones)	1, 2
IECEX gas certificate	IECEX PTB 06.0011U
IECEX gas explosion protection	Ex db eb IIC T6 Gb
IECEX firedamp certificate	IECEX PTB 06.0011U
IECEX firedamp protection	Ex db eb I Mb
ATEX gas certificate	PTB 00 ATEX 1031 U
ATEX gas explosion protection	Ex II 2 G Ex db eb IIC T6 Gb
ATEX firedamp certificate	PTB 00 ATEX 1031 U
ATEX firedamp protection	Ex I M2 Ex db eb I Mb
UL gas certificate	E182378V1S1
Inmetro gas certificate	ULBR130645U
Certificates	ATEX (PTB), Brazil (ULB), Canada / USA (UL), Canada (UL), China (CQST), IECEX (PTB), Korea (KTL), SIL (exida)
Notes	Product label may vary. Series devices are labelled with ATEX, IECEX, NEC and CE Code.

Functional Safety	
SIL-capable	without actuators or with actuators 8602/3-006, 8602/3-009, 8602/3-010, 8602/3-012

Electrical Data	
Max. rated operational voltage	550 V
Min. rated operational voltage	24 V
Rated operational voltage AC UL	600 V
Rated operational current	150 mA / 10 A
UL rated operational current	600 A
Electrical service life	10 ⁶ operating cycles
Mechanical service life	10 ⁶ operating cycles
Switching capacity AC-12	250 V / 10 A 400 V / 7.5 A 550 V / 5 A

Control and signalling devices

Contact element for installat. on mount. rail

Ex e

8082/1-1-00 Art. No. 132636



Electrical Data

Switching capacity AC-15	110 V / 10 A 250 V / 6 A 400 V / 4 A
Switching capacity DC-13	60 V / 6 A
Switching capacity DC-13<SoftReturn/>2 contact elements in series	230 V/1 A 110 V/2.5 A

Ambient Conditions

Ambient temperature	-60 °C ... +70 °C (T6)
Operating temperature	-60 °C ... +100 °C

Mechanical Data

Degree of protection (IP) (IEC 60529)	IP20
Enclosure material	Polyamide
Contact material	Silver-nickel
Silicone-free	Yes
Max. connection cross-section, finely stranded	2,5 mm ²
Solid connection cross section	0.75 – 2.5 mm ²
Finely stranded connection cross section	0.75 – 2.5 mm ²
Connection cross-section, finely stranded with core end sleeve	0.75 – 2.5 mm ²
Number of NCs	1
Positive opening operation	Yes
Contacts	1 NC
Packaging unit	1
Weight	25 g
Weight	0.055 lb

Mounting / Installation

Tightening torque	1.2 Nm
Tightening torque lbf in	10.62 lbf in
Connection type	Screw terminal
Max. USA solid connection terminals	14 AWG

Technical Drawings – Subject to Alterations

11
12
NC

Dimensional Drawings (All Dimensions in mm [inches]) – Subject to Alterations

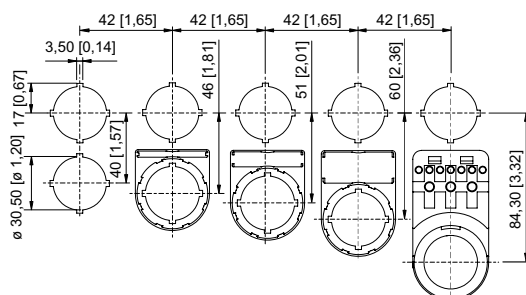
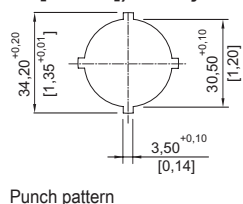
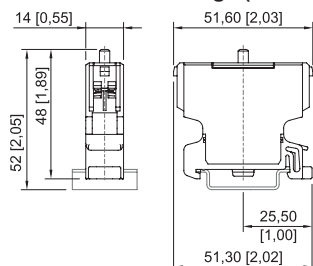

Cut-out with/without additional design plate

Control and signalling devices

Contact element for installat. on mount. rail

Ex e

8082/1-1-00 Art. No. 132636



Accessories

Pushbutton

		Art. No.
	Ø 39 mm Black Designation plate: Black, blank disc without text Front panel mounting Silicone-free: Yes	223691
	Ø 39 mm Black Designation plate: Black, blank disc without text Front panel mounting Silicone-free: No	223692

Mushroom pushbutton, black

		Art. No.
	Ø 39 mm Black Designation plate: Black, blank disc without text Front panel mounting Silicone-free: Yes	244563
	Ø 39 mm Black Designation plate: Black, blank disc without text Front panel mounting Silicone-free: No	244564

Mushroom pushbutton, red

		Art. No.
	Ø 39 mm Red/black Designation plate: Red, blank disc without text Front panel mounting Silicone-free: Yes	244565
	Ø 39 mm Red/black Designation plate: Red, blank disc without text Front panel mounting Silicone-free: No	244566

Mushroom stay-put button with key

		Art. No.
	Ø 39 mm Red/black Closing: MS1 Front panel mounting Silicone-free: Yes	223695
	Ø 39 mm Red/black Closing: MS1 Front panel mounting Silicone-free: No	223696

Control and signalling devices



Contact element for installat. on mount. rail

Ex e

8082/1-1-00 Art. No. 132636



Key-operated switch actuator

		Art. No.
	Ø 39 mm Black Closing: MS1 Number of switching positions: 2 Front panel mounting Switching function: Latching / Latching Silicone-free: No	244574
	Ø 39 mm Black Closing: MS1 Number of switching positions: 3 Front panel mounting Switching function: Latching / Latching / Latching Silicone-free: No	244633

Mushroom stay-put button with EM-STOP key

		Art. No.
	Ø 39 mm Yellow/red Designation plate: With yellow backing plate Closing: MS1 Front panel mounting Silicone-free: Yes	223693
	Ø 39 mm Yellow/red Designation plate: With yellow backing plate Closing: MS1 Front panel mounting Silicone-free: No	223694

Mushroom stay-put button EM-STOP

		Art. No.
	Ø 39 mm Yellow/red Designation plate: With yellow backing plate Front panel mounting Silicone-free: Yes	223697
	Ø 39 mm Yellow/red Designation plate: With yellow backing plate Front panel mounting Silicone-free: No	223698

Mushroom stay-put button, black

		Art. No.
	Ø 39 mm Black Front panel mounting Silicone-free: Yes	223699
	Ø 39 mm Black Front panel mounting Silicone-free: No	223700

Control and signalling devices

Contact element for installat. on mount. rail

Ex e

8082/1-1-00 Art. No. 132636

STAHL

Mushroom pushbutton, 55 mm, red

		Art. No.
	Ø 55 mm Black/red Designation plate: Red, blank disc without text Front panel mounting Silicone-free: Yes	244634
	Ø 55 mm Black/red Designation plate: Red, blank disc without text Front panel mounting Silicone-free: No	244635

Mushroom stay-put button, 55 mm, EM-STOP

		Art. No.
	Ø 55 mm Yellow/red Designation plate: With yellow backing plate Front panel mounting Silicone-free: Yes	244636

Mushroom stay-put button 55 mm EM-STOP

		Art. No.
	Ø 55 mm Yellow/red Designation plate: With yellow backing plate Front panel mounting Silicone-free: No	244637

Twin pushbutton

		Art. No.
	Black Front panel mounting Silicone-free: Yes	244638
	Black Front panel mounting Silicone-free: No	244639

Mushroom pushbutton, 55 mm, black

		Art. No.
	Ø 55 mm Black Designation plate: Black, blank disc without text Front panel mounting Silicone-free: Yes	244642
	Ø 55 mm Black Designation plate: Black, blank disc without text Front panel mounting Silicone-free: No	244643

Control and signalling devices

Contact element for installat. on mount. rail

Ex e

8082/1-1-00 Art. No. 132636



Small rotary actuator, not lockable

		Art. No.
	<p>Ø 39 mm Black Designation plate: 0/OFF – I/ON Number of switching positions: 2 Lockable in: Not padlockable Front panel mounting Switching function: Latching / Latching Silicone-free: Yes</p>	244646

Small rotary actuator, not lockable

		Art. No.
	<p>Ø 39 mm Black Designation plate: 0/OFF – I/ON Number of switching positions: 2 Lockable in: Not padlockable Front panel mounting Switching function: Latching / Latching Silicone-free: No</p>	244647

Small rotary actuator, not lockable

		Art. No.
	<p>Ø 39 mm Black Designation plate: I – 0 – II Number of switching positions: 3 Lockable in: Not padlockable Front panel mounting Switching function: Latching / Latching / Latching Silicone-free: Yes</p>	244648
	<p>Ø 39 mm Black Designation plate: I – 0 – II Number of switching positions: 3 Lockable in: Not padlockable Front panel mounting Switching function: Latching / Latching / Latching Silicone-free: No</p>	244649

Control and signalling devices

Contact element for installat. on mount. rail

Ex e

8082/1-1-00 Art. No. 132636



Rotary actuator, small, lockable

BG727

Art. No.

	<p>Ø 39 mm Black Designation plate: 0/OFF – I/ON Number of switching positions: 2 Lockable in: One pos. with one lock Front panel mounting Switching function: Latching / Latching Silicone-free: Yes</p>	244650
	<p>Ø 39 mm Black Designation plate: 0/OFF – I/ON Number of switching positions: 2 Lockable in: One pos. with one lock Front panel mounting Switching function: Latching / Latching Silicone-free: No</p>	244651
	<p>Ø 39 mm Black Designation plate: I – 0 – II Number of switching positions: 3 Lockable in: One pos. with one lock Front panel mounting Switching function: Latching / Latching / Latching Silicone-free: Yes</p>	244652
	<p>Ø 39 mm Black Designation plate: I – 0 – II Number of switching positions: 3 Lockable in: One pos. with one lock Front panel mounting Switching function: Latching / Latching / Latching Silicone-free: No</p>	244653

Illuminated pushbutton (spring return)

BG735

Art. No.

	<p>Ø 39 mm Black Front panel mounting All colours Silicone-free: Yes</p>	244654
	<p>Ø 39 mm Black Front panel mounting All colours Silicone-free: No</p>	244655

Spare Parts

Mushroom stay-put button with key

BG006

Art. No.

Control and signalling devices

Contact element for installat. on mount. rail

Ex e

8082/1-1-00 Art. No. 132636



Ø 39 mm Red/black Closing: MS2 Front panel mounting Silicone-free: Yes	270409
Ø 39 mm Red/black Closing: MS2 Front panel mounting Silicone-free: No	270412
Ø 39 mm Red/black Closing: MS3 Front panel mounting Silicone-free: Yes	270410
Ø 39 mm Red/black Closing: MS3 Front panel mounting Silicone-free: No	270413
Ø 39 mm Red/black Closing: MS4 Front panel mounting Silicone-free: Yes	270411
Ø 39 mm Red/black Closing: MS4 Front panel mounting Silicone-free: No	270414

Control and signalling devices

Contact element for installat. on mount. rail

Ex e

8082/1-1-00 Art. No. 132636

STAHL

Key-operated switch actuator

BG008

Art. No.

		Art. No.
	<p>Ø 39 mm Black Closing: MS1 Number of switching positions: 2 Front panel mounting Switching function: Latching / Latching Silicone-free: Yes</p>	244573
	<p>Ø 39 mm Black Closing: MS2 Number of switching positions: 2 Front panel mounting Switching function: Latching / Latching Silicone-free: Yes</p>	272935
	<p>Ø 39 mm Black Closing: MS2 Number of switching positions: 2 Front panel mounting Switching function: Latching / Latching Silicone-free: No</p>	270418
	<p>Ø 39 mm Black Closing: MS3 Number of switching positions: 2 Front panel mounting Switching function: Latching / Latching Silicone-free: Yes</p>	274089
	<p>Ø 39 mm Black Closing: MS3 Number of switching positions: 2 Front panel mounting Switching function: Latching / Latching Silicone-free: No</p>	270419
	<p>Ø 39 mm Black Closing: MS4 Number of switching positions: 2 Front panel mounting Switching function: Latching / Latching Silicone-free: Yes</p>	272936
	<p>Ø 39 mm Black Closing: MS4 Number of switching positions: 2 Front panel mounting Switching function: Latching / Latching Silicone-free: No</p>	270420

Control and signalling devices

Contact element for installat. on mount. rail

Ex e

8082/1-1-00 Art. No. 132636

STAHL

	<p>Ø 39 mm Black Closing: MS1 Number of switching positions: 3 Front panel mounting Switching function: Latching / Latching / Latching Silicone-free: Yes</p>	244632
	<p>Ø 39 mm Black Closing: MS2 Number of switching positions: 3 Front panel mounting Switching function: Latching / Latching / Latching Silicone-free: Yes</p>	274090
	<p>Ø 39 mm Black Closing: MS2 Number of switching positions: 3 Front panel mounting Switching function: Latching / Latching / Latching Silicone-free: No</p>	270421
	<p>Ø 39 mm Black Closing: MS3 Number of switching positions: 3 Front panel mounting Switching function: Latching / Latching / Latching Silicone-free: Yes</p>	274091
	<p>Ø 39 mm Black Closing: MS3 Number of switching positions: 3 Front panel mounting Switching function: Latching / Latching / Latching Silicone-free: No</p>	270422
	<p>Ø 39 mm Black Closing: MS4 Number of switching positions: 3 Front panel mounting Switching function: Latching / Latching / Latching Silicone-free: Yes</p>	274092
	<p>Ø 39 mm Black Closing: MS4 Number of switching positions: 3 Front panel mounting Switching function: Latching / Latching / Latching Silicone-free: No</p>	270423

Control and signalling devices

Contact element for installat. on mount. rail

Ex e

8082/1-1-00 Art. No. 132636



Mushroom stay-put button with EM-STOP key

BG009

Art. No.

		Art. No.
	Ø 39 mm Yellow/red Designation plate: With yellow backing plate Closing: MS2 Front panel mounting Silicone-free: Yes	274099
	Ø 39 mm Yellow/red Designation plate: With yellow backing plate Closing: MS2 Front panel mounting Silicone-free: No	270415
	Ø 39 mm Yellow/red Designation plate: With yellow backing plate Closing: MS3 Front panel mounting Silicone-free: Yes	274100
	Ø 39 mm Yellow/red Designation plate: With yellow backing plate Closing: MS3 Front panel mounting Silicone-free: No	270416
	Ø 39 mm Yellow/red Designation plate: With yellow backing plate Closing: MS4 Front panel mounting Silicone-free: Yes	274101
	Ø 39 mm Yellow/red Designation plate: With yellow backing plate Closing: MS4 Front panel mounting Silicone-free: No	270417

We reserve the right to make alterations to the technical data, dimensions, weights, designs and products available without notice. The illustrations cannot be considered binding.